

ELIZA BRYANT VILLAGE

Cleveland, Ohio



Over the course of several years, HGF designed a 100-bed skilled nursing facility, a senior outreach center, a sixty-unit independent living building and, most recently, a two-story, 50,000 square foot nursing expansion.

The interior design theme of the addition incorporates a garden motif with tiled planter walls, trellises, aviaries and aquaria.

The exterior of the addition is sensitive to the existing nursing home structure, yet at the same time provides a new identity for the complex.

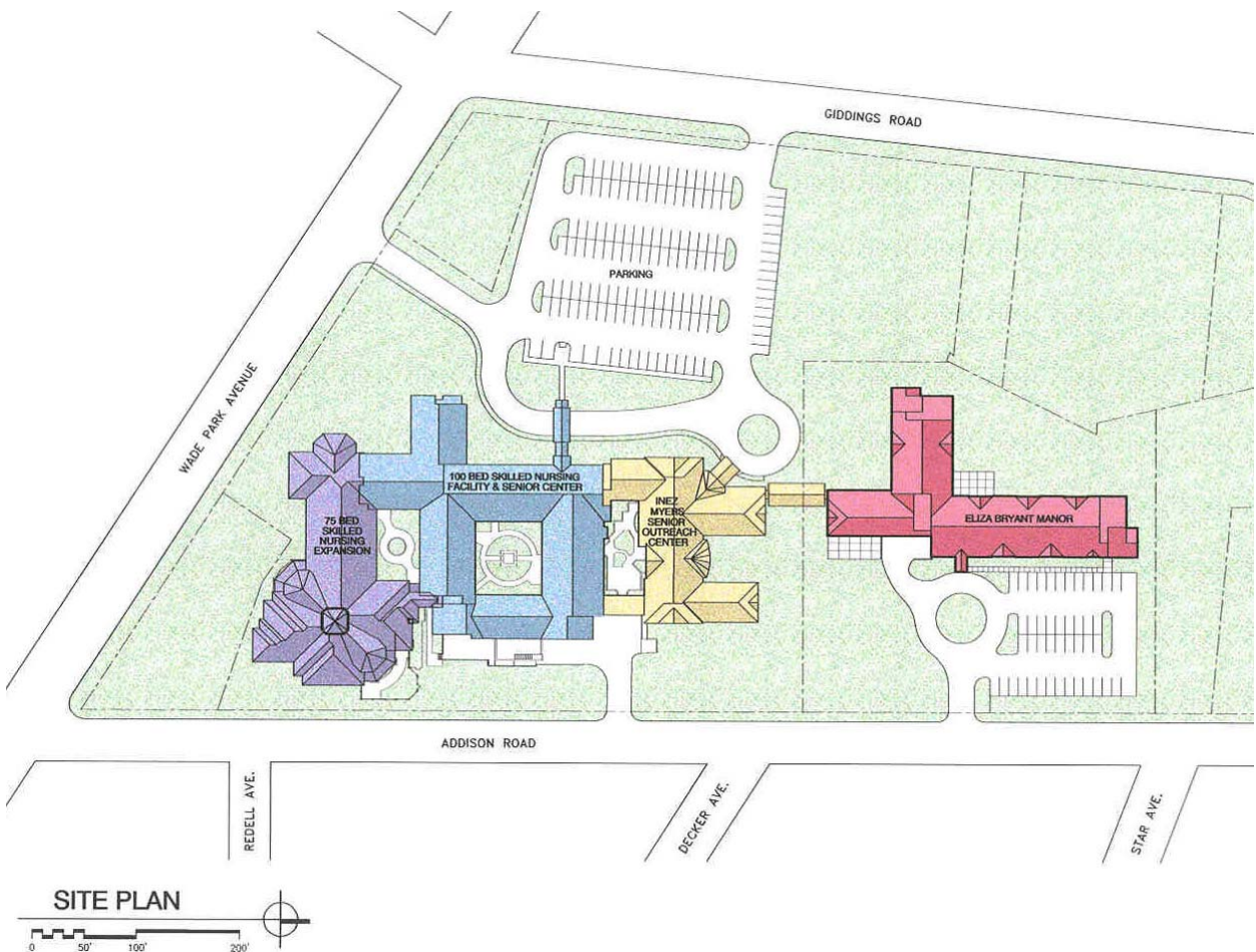

ELIZA BRYANT VILLAGE

Cleveland, Ohio

Over the course of the last twelve years, Herman Gibans Fodor, Inc. has designed several projects for this respected inner-city non-profit nursing home. In 1985 the firm designed a 100 bed skilled nursing facility and multi-purpose center. In 1999 the firm completed an adult day services and senior outreach addition and was the design architect for a new sixty-unit HUD 202 senior housing building. Most recently, HGF designed a seventy six-bed addition to the existing skilled nursing facility.



The new Inez Myers Senior Outreach Center at Eliza Bryant Village is directly linked to the existing nursing home's multi-purpose senior center. This 17,000 square foot expansion includes participant activity rooms, a dining room, and personal care facilities combined with a generous lounge for informal socialization. An interior courtyard and garden provide opportunities for outdoor activities. In addition to the adult day service spaces, both community outreach and expanded administrative areas are accommodated.



The Inez Myers Senior Outreach Center is also connected by an enclosed walkway to the new sixty-unit Eliza Bryant Manor. The apartment building, designed in association with Whitley & Whitley Architects, is laid out in a "T" shaped plan to minimize the distance from resident rooms to the elevator. Common spaces include a 1,500 square foot multi-purpose room, 600 square foot activity room, generous lounge/lobby, laundry room and administrative offices.



ELIZA BRYANT VILLAGE

Cleveland, Ohio

The skilled nursing addition, totaling over 50,000 square feet contains two nineteen-bed neighborhoods dedicated to the care of cognitively impaired residents. The focus of the expansion is the central core of resident activity spaces that include dining, activity and lounge areas. The scope of work also entailed the complete modernization and expansion of the kitchen in the existing building to accommodate the increased number of residents.



The exterior of the addition is designed to be sensitive to the existing nursing home structure, yet at the same time provides a new identity for the complex. This is achieved by employing the original building's red/brown brick as the field color for the new building and enhancing it with bands of buff-colored brick, aluminum panels, green ceramic tiles, as well as standing seam metal roof panels. The entire site was enclosed with a decorative ornamental iron fence and masonry pier system which defines the property in a manner that is responsive to the community.



Awards:

Nursing Home Magazine & Society for the Advancement of Gerontological Environments, *Design 2001*
Selected for Publication

